

Labor and Materials

✓	Copper	Connection	32	\$	
	Lead				
✓	Curb	Cock Valve T.S. & V.	3/4 in	\$	
✓	Service Box	Short 3/4x1/2		\$	
	Old returned	Long 1/2x5/8			
		Buff. or Rdway			
✓	6 Ft. 3/4 in.	Copper Galv. Iron Cast Iron	Pipe at	\$	
	Nipples	in. at		\$	
	Bushings	to in. at		\$	
	Red'g Inc'g	Couplings	to in. at	\$	
	Union	in. at		\$	
	Meter	in. at		\$	
	Lbs. Br. Stone	at		\$	
	Lbs. Sand	at		\$	
	Bags Cement	at		\$	
	Paving Brick	Mack Red Asphalt	at	\$	
	Lead Joints	at		\$	
	Leadite Joints	at		\$	
	Hrs. Foreman	at		\$	
	Hrs. Common Labor	at		\$	
	Hrs. Common Labor	at		\$	
	Hrs. Mason	at		\$	
	Hrs. Mason's Helper	at		\$	
	Hrs. Compressor	at		\$	
	Compensation Ins			\$	
	Trucking			\$	
	Builders' Use of Water			\$	
	Total	\$			

20

Labor and Material Report

Aug 24

1926

3/4 tap at stop loss at

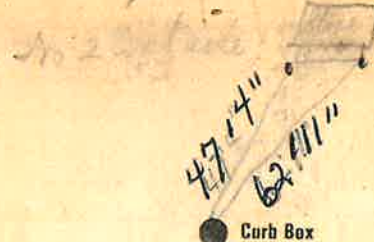

Main

Elev of Main at tap

442

Gate at

Gate at

6' to main
3/4" copper

Jan 29

Curb Box

H Swisky

Labor and Materials

1	Copper	Connection	3/4"	\$
	Lead			
1	Curb	Cock Valve	3/4" in.	\$
		T.S. & V.		
1	Service Box	Short 3 1/2 x 4 1/2		\$
	Old returned	Long 4 1/2 x 5 1/2		
		Buff. or Rdway		
2	Pt.	3/4" in.	Copper Galv. Iron Pipe at	\$
			Cast Iron	
	Nipples	in. at		\$
	Bushings	to in. at		\$
	Red'g	Couplings	to in. at	\$
	Inc'g			
	Union	in. at		\$
	Meter	in. at		\$
	Lbs. Br. Stone	at		\$
	Lbs. Sand	at		\$
	Bags Cement	at		\$
	Paving Brick	Mack Red Asphalt	at	\$
	Lead Joints	at		\$
	Leadite Joints	at		\$
	Hrs. Foreman	at		\$
	Hrs. Common Labor	at		\$
	Hrs. Common Labor	at		\$
	Hrs. Mason	at		\$
	Hrs. Mason's Helper	at		\$
	Hrs. Compressor	at		\$
	Compensation Ins			\$
	Trucking			\$
	Builders' Use of Water			\$
	Total	\$		

Labor and Material Report

1928

at lot 20

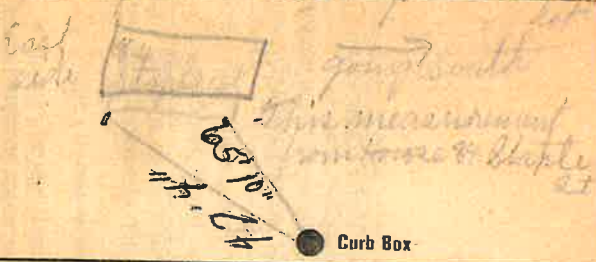

Main Eley of Main at tap 4 1/2

Gate at 9' to main 3/4" copper Gate at

Lot 86 Curb Box

E. H. McCullough