

Labor and Material Report

July 11, 1956

W 46 Staple No.

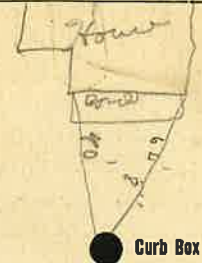

6" Main

Elev. of Main at tap

Gate at

Gate at

Curb Box

Pressure from  
76 Staple

Staple

St. No. 76

Name of Owner

Clifford LaValley

Labor and Mat'l. Report

Aug 17, 1956

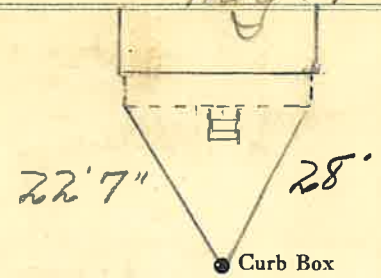

TAX ID# 309.15.3-11

6" Main

Elev. of Main at tap 4'

Gate at

Gate at

3/4" Copper

10' to MAIN

Curb Box

Be sure this  
Curb stop is in  
off position when  
shut off, because top  
turns round and  
ROUND

L M-5C-2-1-54

### Labor and Materials

Lead Connection	.....	\$
Curb Cock	.....	\$
Service Box { Short 3½ x 4½	.....	\$
Old returned { Long 4½ x 5½	.....	\$
Buffalo	.....	\$
2 Ft. 3/8 in. G.I. Pipe at	.....	\$
Nipples..... in. at	.....	\$
Bushings..... to..... in. at	.....	\$
Red'g Coup... to... in. at	.....	\$
Inc'g Coup... to... in. at	.....	\$
Union... in. at	.....	\$
Meter... in. at	.....	\$
Cu. Yds. Br. Stone at	.....	\$
Cu. Yds. Sand at	.....	\$
Bags Cement at	.....	\$
Paving Brick { Mack	.....	\$
Red	.....	\$
Asphalt } at	.....	\$
Hrs. Foreman at	.....	\$
Hrs. Common Labor at	.....	\$
Hrs. Mason at	.....	\$
Hrs. .... at	.....	\$
Hrs. .... at	.....	\$
Builders' Use of Water	.....	\$
..... at	.....	\$
..... at	.....	\$
..... at	.....	\$
..... at	.....	\$
Total	\$	

### LABOR AND MATERIALS

1 Copper } Connection <sup>3/4"</sup>	.....	\$ 3.08
Lead {	.....	
1 Curb { Cock	.....	
Valve } <sup>3/4</sup> in.	.....	\$ 3.89
T.S. & V.	.....	
1 Service box { Short 3½ x 4½	.....	
Old returned { Long 4½ x 5½	.....	
Buff or Rdway	.....	\$ 4.32
10 Ft. <sup>3/4</sup> in. { Copper	.....	
G.I. } Pipe at <sup>4/5</sup>	.....	\$ 4.50
G.I.	.....	
Nipples..... in. at	.....	\$
Bushings..... to..... in. at	.....	\$
Red'g } Coupl'gs..... to..... in. at	.....	\$
Inc'g }	.....	
Union..... in. at	.....	\$
Meter..... in. at	.....	\$
Lead Joints at	.....	\$
Compound Joints at	.....	\$
Maintenance Foreman	.....	\$
Hrs. Water Maint. Man-1 at	.....	\$
4	Hrs. Water Maint. Man-2 at 1.613	\$ 6.45
Hrs. Garage Foreman	at	\$
13	Hrs. Labor..... at 1.30	\$ 16.90
Hrs. Compressor at	.....	\$
Compensation Ins. at \$5.686 per C	.....	\$ 1.33
Trucking	.....	\$ 1.50
Pay't Patch	.....	\$ 11.20
Tap made Aug 17 56	.....	\$
by Gifford	.....	\$
O'head	.....	\$
	.....	\$ 53.17

41-97