

LABOR AND MATERIALS

1	Copper	{ Connection	3/4"	\$
1	Lead	{		
1	Curb	{ Cock Valve T.S. & V.	3/4 in.	\$
1	Service box	{ Short 3 1/2 x 4 1/2		
1	Old returned	{ Long 4 1/2 x 5 1/2		
		{ Buff. or Rdway		\$
24	Ft.	{ Copper		
		{ C.I.		
		{ C.I.		
			Pipe at	\$
	Nipples	in. at		\$
	Bushings	to in. at		\$
	Red'g	{ Coupl'gs	to in. at	\$
	Inc'g	{		
	Union	in. at		\$
	Meter	in. at		\$
	Lead Joints at			\$
	Compound Joints at			\$
	Hrs. Water Maint. Man—1 at			\$
	Hrs. Water Maint. Man—2 at			\$
	Hrs. Labor— at			\$
	Hrs. Labor— at			\$
	Hrs. Compressor at			\$
	Compensation Ins. at \$	per C.		\$
	Trucking			\$
	Pav't Patch			\$
				\$
				\$
				\$
	O'head			\$
				\$

State St. Ave. No.

Name of Owner Williams (MADE OVER ON TREMONT)

Labor and Mat'l. Report Measured in 9/7 19 50

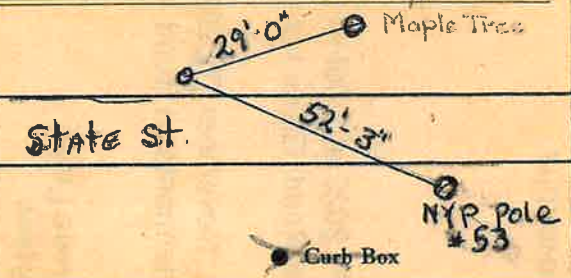

6" Main Elev. of Main at tap 4 1/2

Gate at • Gate at •  
3/4" Copper 24' to MAIN

• Curb Box  
This Tap shut off ON STATE ST. AT ONE TIME WENT TO TREMONT ST. WILLIAMS