

LABOR AND MATERIALS

1 ~~Lead~~ Copper } Connection  $\frac{3}{4}$  in. at \$  
 1 Curb { Cock Valve }  $\frac{3}{4}$  in. at \$ Oriseal  
 T. S. & V. }  
 1 Service Box { Short  $3\frac{1}{2} \times 4\frac{1}{2}$  }  
 Old returned { Long  $4\frac{1}{2} \times 5\frac{1}{2}$  }  
 { Buff. or Rdway }  
 10 Ft.  $\frac{3}{4}$  in. { Copper } Pipe at \$  
 { Galv Iron }  
 { Cast Iron }  
 Nipples in. at \$  
 Bushings to in. at \$  
 Red'g { Couplings to in. at \$  
 Inc'g }  
 Union in. at \$  
 Meter in. at \$  
 Lead Joints at \$  
 Leadite Joints at \$  
 Hrs. Foreman at \$  
 Hrs. Chauffeur at \$  
 Hrs. Tapper at \$  
 Hrs. Labor at \$  
 Hrs. Labor at \$  
 Hrs. Compressor at \$  
 Compensation Ins. \$  
 Trucking \$  
 Builders Use of Water \$  
 Tap by Gifford & Co. \$  
 11-25-68 \$  
 \$  
 \$

St. Pt. Ave. No. 16

*Sterens*

Name of Owner

*Francis G. Tremblay*

Labor and Mat'l. Report

19

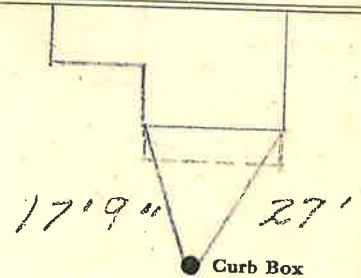

4" Main

Elev. of Main at tap 5'

Gate at ●

● Gate at

*3/4" Copper 10' to main*

● Curb Box

TAX ID # 309.7-6-22