

Labor and Materials

Lead Connection	\$
1 Curb Cock $3/4$	\$
1 Service Box (Short $3\frac{1}{2} \times 4\frac{1}{2}$)	\$
Old returned (Long $4\frac{1}{2} \times 6\frac{1}{2}$)	\$
9 Ft. $3/4$ -in. G. I. Pipe at	\$
1 Nipples $1\frac{1}{2}$ in. at	\$
Bushings	to.....in. at	\$
Red'g Coup	to.....in. at	\$
Inc'g Coup	to.....in. at	\$
Union	in. at	\$
Meter	in. at	\$
Cu. Yds. Br. Stone at	\$
Cu. Yds. Sand at	\$
Bags Cement at	\$
Paving Brick { Mack Red Asphalt } at	\$
4 Hrs. Foreman at	\$
3 Hrs. Common Labor at	\$
Hrs. Mason at	\$
Hrs.	at	\$
Hrs.	at	\$
Builders' Use of Water	\$
Hmr belt	at 75°	\$ 75°
No Labor Charge	at	\$
Total	\$	7.23

Labor and Material Report

Feb 29 1924

Revel at 17 Steward Ave

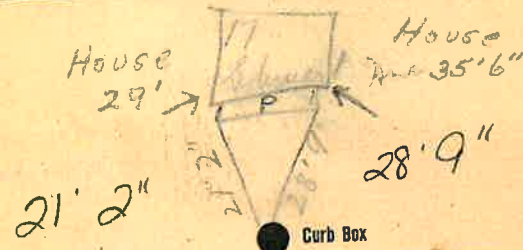

6' Main Elev. of Main at tap 3' 4"

Gate at ● 9' to MAIN Gate at ●

● Curb Box

TAX ID# 309.11-15-17