

Labor and Materials

1	Copper } Connection $\frac{3}{4}$		\$ 1.48
	Lead }		
1	Curb { Cock Valve } $\frac{3}{4}$ in.		\$ 1.79
	{ T.S. & V. }		
1	Service Box { Short 3" x 4" }		\$ 1.30
	Old returned { Long 4" x 5" }		
	{ Buff. or Rdway }		
13	Ft. $\frac{3}{4}$ in. { Copper } Pipe at		\$ 2.34
	{ Galv. Iron }		
	{ Cast Iron }		
	Nipples in. at		\$
1	Bushings $\frac{3}{4}$ to $\frac{1}{2}$ in. at		\$ 1.0
	Red'g } Couplings to in. at		\$
	Inc'g }		
	Union in. at		\$
	Meter in. at		\$
	Lbs. Br. Stone at		\$
	Lbs. Sand at		\$
	Bags Cement at		\$
	Paving Brick { Mack } at		\$
	{ Red }		
	{ Asphalt }		
	Lead Joints at		\$
	Leadite Joints at		\$
1.2	Hrs. Foreman at		\$ 7.50
	Hrs. Common Labor at		\$
	Hrs. Common Labor at		\$
	Hrs. Mason at		\$
	Hrs. Mason's Helper at		\$
	Hrs. Compressor at		\$
	Compensation Ins.		\$.23
	Trucking		\$ 1.00
	Builders' Use of Water <i>Batch</i>		\$ 5.00
Total			\$ 20.94

Labor and Material Report

19

6/15/32 *25*
W 1/2 Stoddard Ave

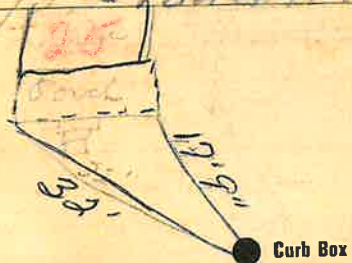

6" Main

Elev. of Main at tap 5'

Gate at

3/4" copper 13' to MAIN

Gate at

Curb Box

Old stop shut off

TAX ID # 302.12-19-4