

Labor and Materials

Copper	Connection.....	\$ 1.25
Lead		
Curb	{ Cock Valve T.S.&V. } in	\$ 1.70
Service Box	{ Short 3 1/2 x 4 1/2 }	\$ 1.45
Old returned	{ Long 4 1/2 x 5 1/2 }	
9 Ft. 3/4 in.	{ Copper Galv. Iron Cast Iron } Pipe at 13/2	\$ 1.22
Nipples in. at	\$
Bushings to in. at	\$
Red'g Inc'g	{ Couplings..... to in. at	\$
Union in. at	\$
Meter in. at	\$
Lbs. Br. Stone	at	\$
Lbs. Sand	at	\$
Bags Cement	at	\$
Paving Brick	{ Mack Red Asphalt } at	\$
Lead Joints	at	\$
Leadite Joints	at	\$
3 Hrs. Foreman	at 6 1/2	\$ 1.88
3 Hrs. Common Labor	at 45	\$ 1.35
Hrs. Common Labor	at	\$
Hrs. Mason	at	\$
Hrs. Masons Helper	at	\$
Hrs. Compressor	at	\$
Compensation Ins		\$ 1.70
Trucking		\$ 1.50
Builders Use of Water		\$

Total \$ 9.97

1935-60

Labor and Material Report

June 11 1935

to Taylor

14?

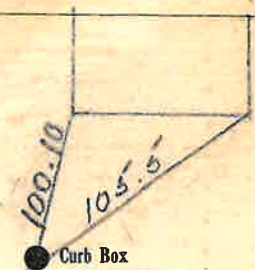

TAX ID # 309.16-5-17

Main

Elev. of Main at tap

Gate at

3/4" copper 9' to main

Gate at

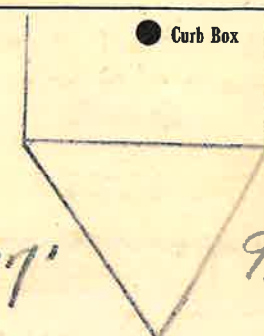

Curb Box in Driveway
6" Down