

**Labor and Materials**

1	Copper } Connection	3/4"	\$320
1	Lead } Curb		
		Cock Valve T-S & V. } 3/4" in.	\$100
1	Service Box	Short 3 1/2 x 4 1/2	\$140
	Old returned	Long 4 1/2 x 5 1/2	
19	Ft. 3/4" in.	Copper Galv. Iron } Pipe at	\$418
		Cast Iron	
	Nipples	in. at	\$
1	Bushings	7/8" to 1" in. at	\$ .08
	Red'g } Couplings	to in. at	\$
	Inc'g }		
	Union	in. at	\$
	Meter	in. at	\$
	Lbs. Br. Stone at		\$
	Lbs. Sand at		\$
	Bags Cement at		\$
	Paving Brick	{ Mack Red Asphalt } at	\$
	Lead Joints at		\$
	Leadite Joints at		\$
3	Hrs. Foreman at	62.5-	\$ 188
6	Hrs. Common Labor at	50	\$ 300
6	Hrs. Common Labor at	40.8	\$ 244
	Hrs. Mason at		\$
	Hrs. Mason's Helper at		\$
	Hrs. Compressor at		\$
	Compensation Ins.	2.2	\$
	Trucking		\$ 100
	Builders' Use of Water		\$
Total			\$1838

76-160 5-  
 Labor and Material Report Oct 1 19 26

1 Terra Cotta

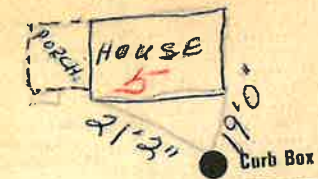

6 Main Elev. of Main at tap 5  
 Gate at 34 Copper Gate at 19' to MAIN  
 Curb Box

TAX ID# 302.12-10-15