

LABOR AND MATERIALS

1. Copper	Connection	3/4	\$ 2.94
1. Lead			
1. Curb	Cock Valve	3/4 in.	\$ 3.71
	T. S. & V.		
1. Service box	Short 3/4 X 4 1/2		
Old returned	Long 4 1/2 X 5 1/2		\$ 5.90
	Buff or Rdway		
8. Ft. 3/4 in.	Copper	Pipe at 30	\$ 2.40
	Nipples	in. at	\$
	Bushings	to in. at	\$
	Red'g		
	Inc'g	Coupl'gs to in. at	\$
	Union	in. at	\$
	Meter	in. at	\$
	Lead Joints	at	\$
	Compound Joints	at	\$
3. Hrs. Water Maint. Man-1	at 1.01	\$ 3.03	
Hrs. Water Maint. Man-2	at	\$	
10. Hrs. Labor-	at 80	\$ 8.00	
Hrs. Labor-	at	\$	
Hrs. Compressor	at	\$	
Compensation Ins.	at \$ per C	\$ 24	
Trucking		\$ 1.00	
Pav't Patch	Before Paving	\$	
Tap by Miller		\$	
O'head		\$	
		\$ 22.22	

103

Terra Cotta

Ave. No. 10

Name of Owner

Mary E Boss

Labor and Mat'l. Report

July 8 1948

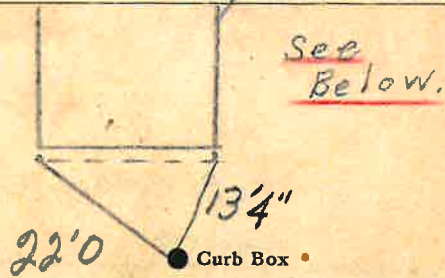

TAX ID # 302.12-7-17

6 Main

Elev. of Main at tap 5

Gate at

Gate at

3/4" Copper 8' to main

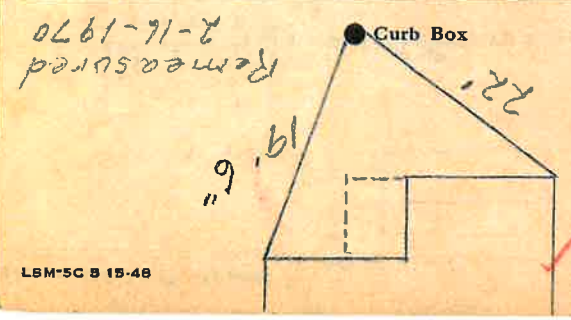

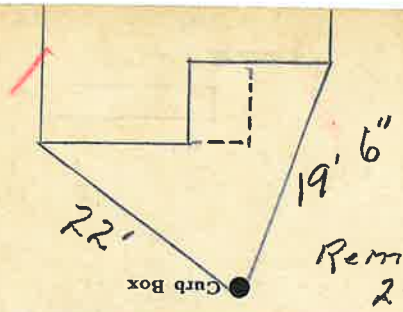

Remeasured
2-16-1970

● Curb Box

3/4" Copps
8' to main

● Gate at

Main
Elev. of Main at tap 5

TAX ID # 302.12-7-17

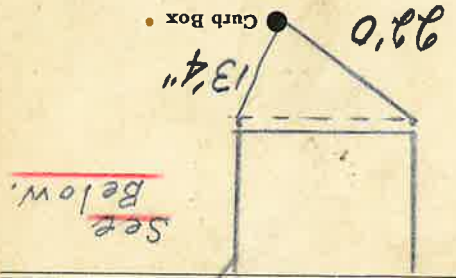

See
Below.

22'0"

● Curb Box

Labor and Mat'l. Report
July 8
1948

Name of Owner
Mary E. Boss

Terpa Cotta
Ave. No. 10