

Labor and Materials

1	Copper } Connection	3/4"	\$ 2.60
	Lead		
1	Curb } Cock	3/4" in.	\$ 2.27
	Valve		
	T. S. & V.		
1	Service Box } Short 3/4x4 1/2		\$ 1.38
	Old returned } Long 1 1/2x5 1/2		
		Buff or Redway	
8	Pt. 3/4" in. } Copper	Pipe at	\$ 1.44
		Galv. Iron	
		Cast Iron	
	Nipples	in. at	\$
	Bushings	to in. at	\$
	Red'g } Couplings	to in. at	\$
	Inc'g		
	Union	in. at	\$
	Meter	in. at	\$
	Lbs. Br. Stone	at	\$
	Lbs. Sand	at	\$
	Bags Cement	at	\$
	Paving Brick } Mack	at	\$
		Red	
		Asphalt	
	Lead Joints	at	\$
	Leadite Joints	at	\$
2	Hrs. Foreman	at	\$ 1.25
1.0	Hrs. Common Labor	at	\$ 4.50
	Hrs. Common Labor	at	\$
	Hrs. Mason	at	\$
	Hrs. Mason's Helper	at	\$
	Hrs. Compressor	at	\$
	Compensation Ins		\$ 1.8
	Trucking		\$ 1.00
	Builders' Use of Water	Patel	\$ 5.00
Total			\$ 19.62

31-80

Labor and Material Report

July 13

1981

115 Third St 3/4" tap

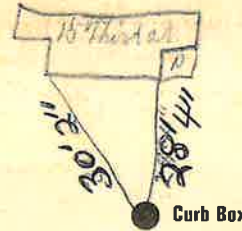

Curb Box

6" Main

Elev of Main at tap 4 1/4

Gate at 3/4" Copper

8' to main

Curb Box

Old tap shut off
TAX ID# 309.12-10-35