

Labor and Materials

1	Copper	Connection	3/4"	\$	2.60
1	Curb	Cock Valve	3/4" in.	\$	2.30
1	Service Box	Short	3 1/2 x 4 1/2	\$	1.40
	Old returned	Long	4 1/2 x 5 1/2		
		Buff. or Rdway			
11	Ft.	3/4" in.	Copper Galv. Iron Pipe at	\$	2.92
	Nipples	in. at		\$	
	Bushings	to in. at		\$	
	Red'g Inc'g	Couplings	to in. at	\$	
	Union	in. at		\$	
	Meter	in. at		\$	
	Lbs. Br. Stone	at		\$	
	Lbs. Sand	at		\$	
	Bags Cement	at		\$	
	Paving Brick	Mack Red Asphalt	at	\$	
	Lead Joints	at		\$	
	Leadite Joints	at		\$	
3	Hrs. Foreman	at		\$	1.88
11	Hrs. Common Labor	at		\$	4.47
	Hrs. Common Labor	at		\$	
	Hrs. Mason	at		\$	
	Hrs. Mason's Helper	at		\$	
	Hrs. Compressor	at		\$	
	Compensation Ins.			\$.17
	Trucking			\$	1.00
	Builders' Use of Water	Patch		\$	5.00
Total				\$	21.74

29-172

Labor and Material Report

1929

25 1942 Third St.

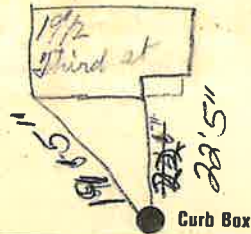

6" Main

Elev of Main at tap 4 1/2'

Gate at

3/4 Copper

11' to MAIN Gate at

Curb Box

Old tap shut off

TAX ID# 309.12.10.32