

LABOR AND MATERIALS

1	Copper Lead-Connection		\$ 1.23
1	Curb { Cock Valve } { I. S. & V. }	in.	\$ 1.68
1	Service Box Old-retained { Short 3 1/2 x 4 1/2 } { Long 4 1/2 x 5 1/2 } { Buff. or Rdway }		\$ 1.54
20	Ft. 3/4 in. { Copper Galv Iron } { Cast Iron }	Pipe at	17 \$ 3.40
	Nipples	in. at	\$
	Bushings	to in. at	\$
	Red'g Inc'g } Couplings	to in. at	\$
	Union	in. at	\$
	Meter	in. at	\$
	Lead Joints	at	\$
	Leadite Joints	at	\$
	Hrs. Foreman	at	\$
4	Hrs. Chauffeur	at 6 1/2 hr	\$ 2.50
5	Hrs. Tapper	at	\$ 3.13
5	Hrs. Labor	at 4 1/2	\$ 2.25
	Hrs. Labor	at	\$
	Hrs. Compressor	at	\$
	Compensation Ins.		\$.24
	Trucking		\$ 1.24
	Builders Use of Water	no pitch -	\$
	Truck by Person		\$
			\$
			\$
			\$
			\$
			\$ 16.97

90 - - 1939

St. 5
Pt. -
Ave. No. 7

Third

Name of Owner

Scoville

Labor and Mat'l. Report

Sept 12 1939

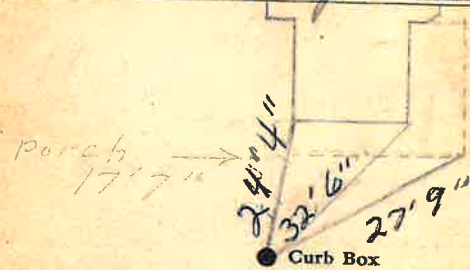

6 Main

Elev. of Main at tap 5

Gate at ●

● Gate at

74 copper

20' to MAIN

● Curb Box

to be billed

TAX PD# 309.12-10-40

old shut off

TH