

### Labor and Materials

1	Copper	Connection.	3/4"			\$ 2.60
	Lead					
1	Curb	Cock Valve	3/4"	in.		\$ 2.30
		T.S. & V.				
1	Service Box	Short	3 1/2 x 4 1/2			\$ 1.40
	Old returned	Long	4 1/2 x 5 1/2			
		Buff. or Rdway				
23	Ft.	3/4" in.	Copper Galv. Iron	Pipe at		\$ 6.10
			Cast Iron			
	Nipples	in. at				\$
	Bushings	to in. at				\$
	Red'g Inc'g	Couplings	to in. at			\$
	Union	in. at				\$
	Meter	in. at				\$
	Lbs. Br. Stone	at				\$
	Lbs. Sand	at				\$
	Bags Cement	at				\$
	Paving Brick	Mack Red Asphalt	at			\$
	Lead Joints	at				\$
	Leadite Joints	at				\$
4	Hrs. Foreman	at				\$ 2.50
2.8	Hrs. Common Labor	at				\$ 11.35
	Hrs. Common Labor	at				\$
	Hrs. Mason	at				\$
	Hrs. Mason's Helper	at				\$
	Hrs. Compressor	at				\$
	Compensation Ins					\$ .37
	Trucking					\$ 1.00
	Builders' Use of Water	Patch				\$ 5.00
Total \$						32.65

29-164

Labor and Material Report

Nov 1

1929

87 Third St.

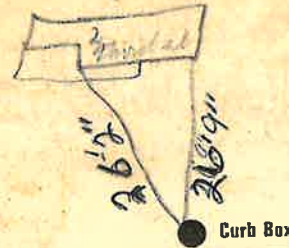

Curb Box

6

Main

Elev of Main at tap

4.1

Gate at

3/4" Copper

Gate at

23' to MAIN

Curb Box

Old tap shut off

TAX ID# 309.12.13.7