

LABOR AND MATERIALS

1	Copper	Lead	Connection	3/4		\$ 2.94
1	Curb	Cock Valve	3/4 in.			\$ 3.71
1	Service box	Old returned	Short 3 1/2 X 4 1/2			\$ 5.90
			Long 4 1/2 X 5 1/2			
			Buff or Rdway			
8	Ft.	3/4 in.	Copper	Pipe at	30	\$ 2.40
			G.I.			
			G.I.			
	Nipples	in. at				\$
	Bushings	to in. at				\$
	Red'g					\$
	Inc'g	Coupl'gs to in. at				\$
	Union	in. at				\$
	Meter	in. at				\$
	Lead Joints	at				\$
	Compound Joints	at				\$
1	Hrs. Water Maint. Man	—1 at				\$ 1.12
1	Hrs. Water Maint. Man	—2 at				\$ 1.02
3	Hrs. Labor	— at				\$ 2.73
	Hrs. Labor	— at				\$
	Hrs. Compressor	at				\$
	Compensation Ins.	at \$ per C.				\$ 1.14
	Trucking					\$ 1.00
	Pav't Patch					\$
	Tap by Mfg. Co.					\$
	O'head					\$
						\$ 20.93

78

St. ?
Pl. ?
Ave. No. 81

third st

Name of Owner
Sweet

Labor and Mat'l. Report Nov 10 1948

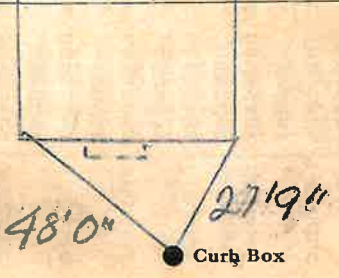

6 Main Elev. of Main at tap 5'

Gate at ● ● Gate at

3/4" Copper 8' to main

● Curb Box