

### LABOR AND MATERIALS

1. Copper Connection 3/4	\$2.87
1. Lead	
1. Curb Cock Valve T-S & V. { 3/4 in.	\$3.62
1. Service box { Short 3/2 X 4 1/2 } Old returned { Long 4 1/2 X 5 1/2 } { Buff or Rdway }	\$4.65
25 3/4 Ft. in. { Copper } Pipe at 32	\$8.00
{ G. I. }	
{ C. I. }	
..... Nipples ..... in. at	\$
..... Bushings ..... to ..... in. at	\$
..... Red'g	
..... Inc'g { Coupl'gs ..... to ..... in. at	\$
..... Union ..... in. at	\$
..... Meter ..... in. at	\$
..... Lead Joints at	\$
..... Compound Joints at	\$
..... Hrs. Water Maint. Man-1 at	\$
..... Hrs. Water Maint. Man-2 at	\$1.02
4. Hrs. Labor ..... at 91	\$3.64
..... Hrs. Labor ..... at	\$
..... Hrs. Compressor at	\$
..... Compensation Ins. at \$ ..... per C.	\$10
..... Trucking	\$2
..... Pav't Patch	\$
..... Twp. by Medina	\$
..... O'head	\$
	\$25.93

36

St. ~~Pl~~  
Ave. No. 96

third  
Name of Owner TAX ID# 309.11-9-6  
Sweet

MEASURED IN 8/30/70 Leon  
Labor and Mat'l. Report May 18 1979

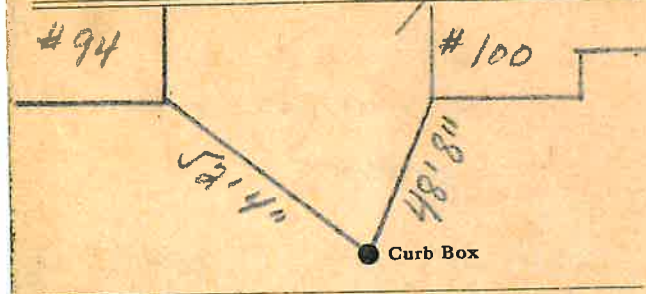

THIRD ST.

6 Main Elev. of Main at tap 6

Gate at ● Gate at ●

3/4" COPPER 25' to MAIN

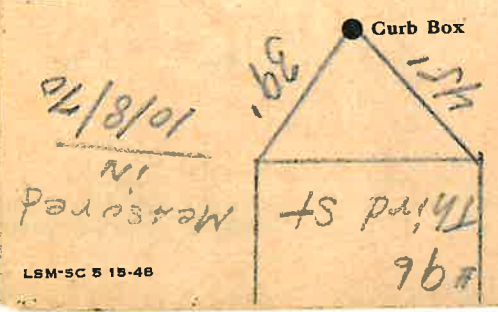

LSM-SC 5 15-48

St. Hill Ave. No. 96

Name of Owner TAX ID # 30911-9-6

Sweet

Measured in 8/20/70 from Labor and Mat'l. Report May 18 1949



THIRD ST.

Elev. of Main 6

Main Gate at

3/4" copper 25' to main Gate at

