

LABOR AND MATERIALS

1	Copper Lead	Connection	3/4"	\$
1	Curb	Cock Valve T. S. & V.	3/4" in. <i>Oriseat?</i>	\$
1	Service box	Short 3 1/2 x 4 1/2		\$
	Old returned	Long 4 1/2 x 5 1/2		\$
		Buff or Rdway		\$
11	Ft.	3/4" in. { Copper C.I. C.I. }	Pipe at	\$
	Nipples	in. at		\$
	Bushings	to in. at		\$
	Red'g Inc'g	Coupl'gs to in. at		\$
	Union	in. at		\$
	Meter	in. at		\$
	Lead Joints at			\$
	Compound Joints at			\$
	Maintenance Foreman			\$
	Hrs. Water Maint. Man-1 at			\$
	Hrs. Water Maint. Man-2 at			\$
	Hrs. Garage Foreman at			\$
	Hrs. Labor at			\$
	Hrs. Compressor at			\$
	Compensation Ins. at \$	per C		\$
	Trucking			\$
	Pav't Patch			\$
	Tap by Gifford			\$
	Cor 1-4-63			\$
	O'head			\$

Thomas
 St. Pl. Ave. No. 26

Name of Owner
 John Martel

Labor and Mat'l. Report Jan 4 1963

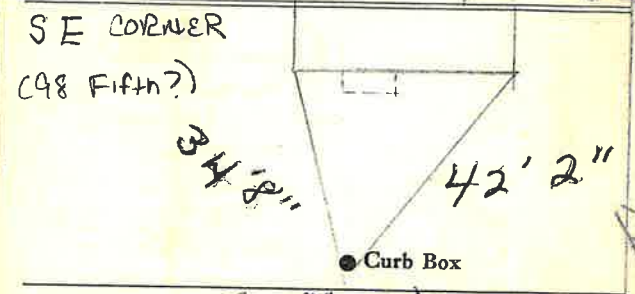

Fifth St.
 6 Main C.I. Elev. of Main at tap 5

Gate at • Gate at •
 3/4" copper 11' to main

• Curb Box
 Tap on Fifth St Side.