

LABOR AND MATERIALS

1	Copper	{ Connection	3/4		
	Lead				\$ 2.29
1	Curb	{ Cock Valve	3/4 in.		\$ 2.70
		{ T.S. & V.			
1	Service box	{ Short 3 1/2 x 4 1/2			
	Old returned	{ Long 4 1/2 x 5 1/2			\$ 4.25
		{ Buff or Rdway			
15 Ft.	3/4 in.	{ Copper			
		{ G.I.			
		{ C.I.	Pipe at 35		\$ 5.25
	Nipples	in. at			\$
	Bushings	to in. at			\$
	Red'g Inc'g	{ Coupl'gs to in. at			\$
	Union	in. at			\$
	Meter	in. at			\$
	Lead Joints at				\$
	Compound Joints at				\$
	Hrs. Water Maint. Man	1 at			\$
2	Hrs. Water Maint. Man	2 at	1.02		\$ 2.04
2	Hrs. Labor	at	91		\$ 1.82
	Hrs. Labor	at			\$
	Hrs. Compressor at				\$
	Compensation Ins. at \$	per C.			\$ 1.09
	Trucking				\$ 1.00
	Pav't Patch				\$
					\$
					\$
	O'head				\$
					\$ 19.44

49-150

St.
Pl.
Ave. No.

Thomas

Name of Owner

Horton

Labor and Mat'l. Report Apr 25 1958

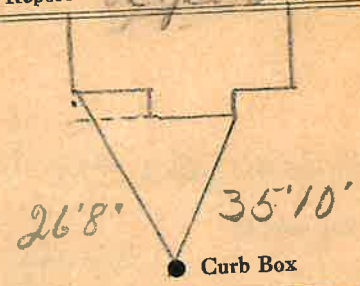

12 Main

Elev. of Main at tap 5-

Gate at ●

● Gate at

3/4" Copper 15' to MAIN

● Curb Box