

### LABOR AND MATERIALS

1	Copper	Connection	<u>3/4"</u>	\$	
	Lead	Cock		\$	
		Valve	<u>3/4"</u>	\$	
	1	T. S. & V.		\$	
		Service box	Short $3\frac{1}{2} \times 4\frac{1}{2}$	\$	
		Old returned	Long $4\frac{1}{2} \times 5\frac{1}{2}$	\$	
			Buff or Rdway	\$	
	27	Ft. <u>3/4"</u> in.	Copper	\$	
			G. I.	\$	
			C. I.	\$	
			Pipe at	\$	
		Nipples	in. at	\$	
		Bushings	to in. at	\$	
		Red'g		\$	
		Inc'g	Coupl'gs to in. at	\$	
		Union	in. at	\$	
		Meter	in. at	\$	
		Lead Joints	at	\$	
		Compound Joints	at	\$	
		Maintenance Foreman		\$	
		Hrs. Water Maint. Man	1 at	\$	
		Hrs. Water Maint. Man	2 at	\$	
		Hrs. Garage Foreman	at	\$	
		Hrs. Labor	at	\$	
		Hrs. Compressor	at	\$	
		Compensation Ins.	at \$ per C	\$	
		Trucking		\$	
		Pav't Patch		\$	
		<u>Tap by Gissord &amp; Co.</u>			\$
		<u>9-14-60.</u>			\$
		O'head		\$	

St. Pl.  
Ave. No. 21

Name of Owner Walter Cross.

Labor and Mat'l. Report Sept. 14 1960.

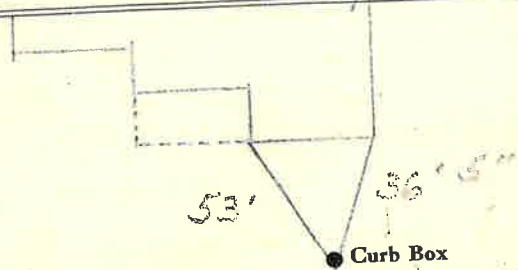

6" C.I. Main      Elev. of Main at tap 4'

Gate at ●      ● Gate at

27' to main

3/4" Copper ● Curb Box

TAX ID # 303.13-12-6