

LABOR AND MATERIALS

1	Copper	} Connection	$\frac{3}{4}$ "	\$	_____
1	Lead				
1	Curb	} Cock Valve T.S. & V.	$\frac{3}{4}$ in.	\$	_____
1	Service box		} Short $3\frac{1}{2}$ x $4\frac{1}{2}$ Long $4\frac{1}{2}$ x $5\frac{1}{2}$ Buff or Rdway		\$
25	Ft.	} Copper G.I. C.I.		$\frac{3}{4}$ in.	Pipe at
	Nipples		in. at	\$	_____
	Bushings		to in. at	\$	_____
	Red'g	} Coupl'gs	to in. at	\$	_____
	Inc'g				
	Union		in. at	\$	_____
	Meter		in. at	\$	_____
	Lead Joints at			\$	_____
	Compound Joints at			\$	_____
	Maintenance Foreman			\$	_____
	Hrs. Water Maint. Man	1 at		\$	_____
	Hrs. Water Maint. Man	2 at		\$	_____
	Hrs. Garage Foreman	at		\$	_____
	Hrs. Labor	at		\$	_____
	Hrs. Compressor at			\$	_____
	Compensation Ins. at \$	per C.		\$	_____
	Trucking			\$	_____
	Pav't Patch			\$	_____
	Tap by Gifford & Co.				
	1-21-67.				
	O'head			\$	_____

Tap made when main was layed.

Wallace
Taboe
Dr. St. Pl. Ave. No. 93

Name of Owner John Wheeler.

Labor and Mat'l. Report Jan. 21 19 67

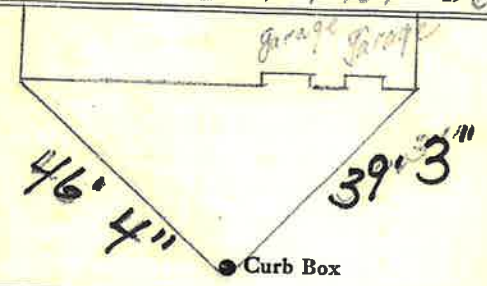

6" Main Elev. of Main at tap

Gate at Gate at
 $\frac{3}{4}$ " COPPER 25' to MAIN

● Curb Box

TAX ID # 303.13-6-3