

Labor and Materials

1	Copper	Connection	$\frac{3}{4}$	\$	2.60
1	Curb	Cock Valve P.S. & V.	in. $\frac{3}{4}$	\$	2.30
1	Service Box	Short 3/4" Long 4 1/2" x 5 1/2" Buff. or Rdway		\$	1.50
26	Pt.	8" Copper Cast Iron	in. $\frac{3}{4}$	\$	6.36
	Nipples	in. at	$\frac{3}{4}$	\$	
	Bushings	to in. at		\$	
	Red'g Inc'g	Couplings to in. at		\$	
	Union	in. at		\$	
	Meter	in. at		\$	
	Lbs. Br. Stone	at		\$	
	Lbs. Sand	at		\$	
	Bags Cement	at		\$	
	Paving Brick	Mack Red Asphalt at		\$	
	Lead Joints	at		\$	
	Leadite Joints	at		\$	
4	Hrs. Foreman	at		\$	2.50
4	Hrs. Common Labor	at		\$	2.00
18	Hrs. Common Labor	at		\$	7.31
	Hrs. Mason	at		\$	
	Hrs. Mason's Helper	at		\$	
	Hrs. Compressor	at		\$	
	Compensation Ins.			\$.31
	Trucking			\$	1.00
	Builders' Use of Water	P.a.t.e.k.v.		\$	5.10

26' 8" COPPER TO MAIN. Total \$ 30.88

MAIN. KH 7-16-2003

29-76 Labor and Material Report June 21 19 27

10 Walnut St.

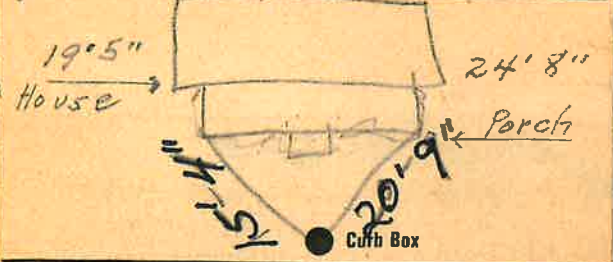

4 Main Elev of Main at tap 5 1/2

Gate at 3/4 Copper Gate at 26' 8" to MAIN

● Curb Box

old house
 down on ~~at~~
 Top by it self.
 did take walls from
 No 12.
 TAX ID# 303.17-11-2