

Labor and Materials

| | | | | |
|----------|------------------------|---------------------------------|----------------|----------|
| 1 | Copper | Connection | 6" gate valves | \$ 19.32 |
| | Lead | | | |
| 1 | Curb | Cock Valve T.S. & V. | 6" in. | \$ 42.36 |
| | Service Box | Short 3/4" x 1/2" | } gate box | \$ 5.- |
| | Old returned | Long 1/2" x 3/4" Buff. or Rdway | | |
| 49 | Ft. 6" | Copper Galv. Iron Cast Iron | Pipe at 5.31 | \$ 76.22 |
| | Nipples | in. at | | \$ |
| | Bushings | to in. at | | \$ |
| | Red g Inc'g | Couplings | to in. at | \$ |
| | Union | in. at | | \$ |
| | Meter | in. at | | \$ |
| | Lbs. Br. Stone | at | | \$ |
| | Lbs. Sand | at | | \$ |
| | Bags Cement | at | | \$ |
| | Paving Brick | Mack Red Asphalt | at | \$ |
| 2 | Lead Joints | at 10" | | \$ 4.57 |
| 5 | Leadite Joints | at 6" | | \$ 2.60 |
| 18 | Hrs. Foreman | at chauffeur | | \$ 42.50 |
| 37 | Hrs. Common Labor | at | | \$ 19.- |
| 65 | Hrs. Common Labor | at | | \$ 29.25 |
| | Hrs. Mason | at | | \$ |
| | Hrs. Mason's Helper | at | | \$ |
| 7 | Hrs. Compressor | at | | \$ 10.50 |
| | Compensation Ins | | | \$ 2.73 |
| | Trucking | | | \$ 10.- |
| | Builders' Use of Water | Patch (2) | | \$ 46.- |
| Total \$ | | | | 260.04 |

31-63

Labor and Material Report

Oct 5 15-17 1931

6" tap at Warren at

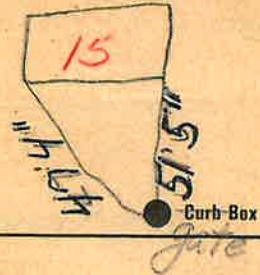

10" Main

Elev of Main at tap 4 1/2

Gate at ●

● Gate at

49' 40" MAIN

● Curb Box

Sprinkler

System

6" gate shut off
Near main 10-7-68

To be razed. Not on map 10/2022
Urban Renewal