

LABOR AND MATERIALS

/	Copper Lead	{ Connection	3/4	-----	\$
1	Curb	{ Cock Valve	3/4	in.	\$
same		{ T. S. & V.			
	Service Box	{ Short 3 1/2 x 4 1/2			\$
	Old returned	{ Long 4 1/2 x 5 1/2			\$
		{ Buff. or Rdway			
36	Ft. 3/4	{ Copper		Pipe at	\$
		{ Galv Iron			
		{ Cast Iron			
	Nipples	in. at	3/4	Buses	\$
1	Bushings	to	3/4	in. at	\$
	Red'g Inc'g	{ Couplings		to	in. at
					\$
	Union	in. at			\$
	Meter	in. at			\$
	Lead Joints	at			\$
	Leadite Joints	at			\$
	Hrs. Foreman	at			\$
	Hrs. Chauffeur	at			\$
	Hrs. Tapper	at			\$
	Hrs. Labor	at			\$
	Hrs. Labor	at			\$
	Hrs. Compressor	at			\$
	Compensation Ins.				\$
	Trucking				\$
	Builders Use of Water				\$
	Tap by G. I. ... & Co.				\$
	5-5-59				\$
					\$
					\$
					\$

St. 293
 PI.
 Ave. No. 135

Warren
 Name of Owner Coriello Bros.
 Glen's Falls Auto Glass Co.

Labor and Mat'l. Report May 5 1959

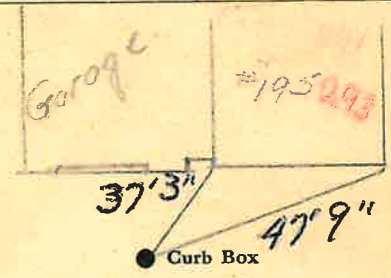

6" Main Elev. of Main at tap 6'

Gate at ● Gate at ●
 3/4" Copper 36' to main

● Curb Box