

Labor and Materials

Copper	Connection	\$	
Lead		\$	
1	Curb	Cock Valve	1" in.....	\$
		T.S. & V.		
1	Service Box	Short 3/4x1 1/2		\$
		Long 4 1/2x5 1/2		
	Old returned	Buff. or Rdway		\$
7	Ft. 1" in.	Copper	Pipe at.....	\$
		Galv. Iron		
		Cast Iron		\$
	Nipples	in. at.....	\$	
	Bushings	to in. at.....	\$	
1	Red' Lac'r	Couplings	to in. at.....	\$
	Union	in. at.....	\$	
	Meter	in. at.....	\$	
	Lbs. Br. Stone	at.....	\$	
	Lbs. Sand	at.....	\$	
	Bags Cement	at.....	\$	
	Paving Brick	Mack	at.....	\$
		Red		
		Asphalt		
	Lead Joints	at.....	\$	
	Leadite Joints	at.....	\$	
	Hrs. Foreman	at.....	\$	
	Hrs. Common Labor	at.....	\$	
	Hrs. Common Labor	at.....	\$	
	Hrs. Mason	at.....	\$	
	Hrs. Mason's Helper	at.....	\$	
	Hrs. Compressor	at.....	\$	
	Compensation Ins.	\$	
	Trucking	\$	
	Builders' Use of Water	\$	

Total \$.....

Labor and Material Report

Dec 10

1931

7" Extension at 284 30 main

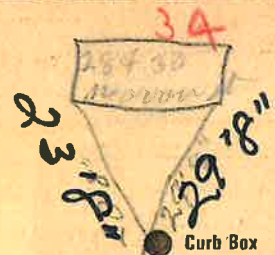

10 Main

Elev of Main at tap 4.4

Gate at ●

Gate at ●

7' to main

● Curb Box

TAX ID # 303.17-16-14

shut off at curb 10-22-68