

Labor and Materials

Copper	Connection	3	\$ 2.70
Lead			
Curb	Cock Valve T.S. & V. in.	4	\$ 2.39
Service Box	Short 3/4x1 1/2		\$ 1.45
Old returned	Long 1 1/2x5 1/2 Buff. or Rd way		
9 Ft.	Copper Galv. Iron Cast Iron Pipe at	3	\$ 2.43
Nipples	in. at	7	\$
Bushings	to in. at		\$
Red'g Inc'g	Couplings to in. at		\$
Union	in. at		\$
Meter	in. at		\$
Lbs. Br. Stone	at		\$
Lbs. Sand	at		\$
Bags Cement	at		\$
Paving Brick	Mack Red Asphalt at		\$
Lead Joints	at		\$
Leadite Joints	at		\$
3 Hrs.	Foreman at		\$ 1.88
3 Hrs.	Common Labor at Tapper		\$ 1.50
8 Hrs.	Common Labor at		\$ 3.60
Hrs.	Mason at		\$
Hrs.	Mason's Helper at		\$
2 Hrs.	Compressor at		\$ 3.-
Compensation Ins			\$ 22
Trucking			\$ 1.-
Builders' Use of Water	Potah		25.-
Total			\$ 45.17

30-146

Labor and Material Report

24 1930

86

Warren H.

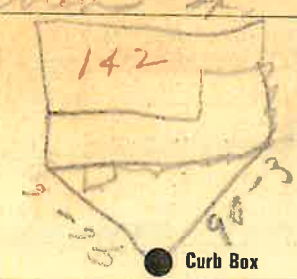

10 Main

Elev of Main at tap 5

Gate at

Gate at

9' to MAIN

Curb Box

Old Tap Disc.

TAX ID # 303.17-21-12