

**Labor and Materials**

1	Copper } Connection	2 1/4	\$	3.20
	Lead			
1	Curb } Cock Valve	3 in.	\$	1.00
		T.S. & V.		
1	Service Box } Short 3 1/2 x 4 1/2		\$	1.30
	Old returned	Long 4 1/2 x 5 1/2		
		Built on Rdway		
16	Ft. } 3/4 in. } Copper		\$	3.52
		Galv. Iron		
		Cast Iron		
	Nipples	in. at	\$	
	Bushings	to in. at	\$	
	Red'g } Couplings	to in. at	\$	
	Inc'g			
	Union	in. at	\$	
	Meter	in. at	\$	
	Lbs. Br. Stone	at	\$	
	Lbs. Sand	at	\$	
	Bags Cement	at	\$	
	Paving Brick } Mack		\$	
		Red		
		Asphalt		
	Lead Joints	at	\$	
	Leadite Joints	at	\$	
1	Hrs. Foreman	at 6.25	\$	6.3
6	Hrs. Common Labor	at 5.0	\$	3.00
	Hrs. Common Labor	at	\$	
	Hrs. Mason	at	\$	
	Hrs. Mason's Helper	at	\$	
	Hrs. Compressor	at	\$	
	Compensation Ins.		\$	1.0
1/4	Trucking		\$	1.00
1/4	Builders' Use of Water		\$	
	<b>Total</b>		\$	<b>13.75</b>

#158  
**Labor and Material Report** April 27 1927

no 94 1/2 Warren St.

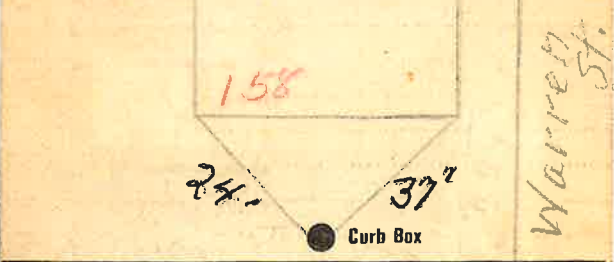

Keenan St.

Main Elev. of Main at tap 43

Gate at ● Gate at ●  
 3/4" Copper 16' to main  
 ● Curb Box

new Tap.

TAX ID # 303.17-22-9