

LABOR AND MATERIALS

| | | | | | |
|-------|-------------------------|-----------------------|--------------------|----|--------|
| 1 | Copper Lead | Connection | 3/4" | \$ | 2.76 |
| 1 | Curb | Cock Valve T. S. & V. | 3/4 in. | \$ | 3.49 |
| 1 | Service box | Short 3 1/2 X 4 1/2 | | \$ | 4.75 |
| | Old returned | Long 4 1/2 X 5 1/2 | | \$ | |
| | | Buffer Rdway | | \$ | |
| 34 | Ft. | Copper G. I. C. I. | 3/4 in. Pipe at 35 | \$ | 11.90 |
| | Nipples | in. at | | \$ | |
| | Bushings | to in. at | | \$ | |
| | Inc'g | Red'g Coupl'gs | to in. at | \$ | |
| | Union | in. at | | \$ | |
| | Meter | in. at | | \$ | |
| | Lead Joints | at | | \$ | |
| 3 | Compound Joints | at Fran | 1.44 | \$ | 4.32 |
| 16 | Hrs. Water Maint. Man-1 | at | 1.34 | \$ | 21.44 |
| 2 | Hrs. Water Maint. Man-2 | at | 1.24 | \$ | 2.48 |
| 5 1/2 | Hrs. Labor | at | 1.13 | \$ | 58.76 |
| 1 | Hrs. Labor | at | .75 | \$ | .75 |
| 4 | Hrs. Compressor | at | 1.50 | \$ | 6.00 |
| | Compensation Ins. | at \$ 7.06 per C | | \$ | 3.25 |
| | Trucking | | | \$ | 1.00 |
| | Pav't Patch | | | \$ | 28.56 |
| | Tap by Warren S. K. I. | | | \$ | |
| | 8-8-52 | | | \$ | |
| | O'head | | | \$ | |
| | | | | \$ | 149.46 |

17090

St. Warren Pl. Ave. No. 191

Name of Owner Frank Colaprete

Labor and Mat'l. Report Aug. 8 - 1952

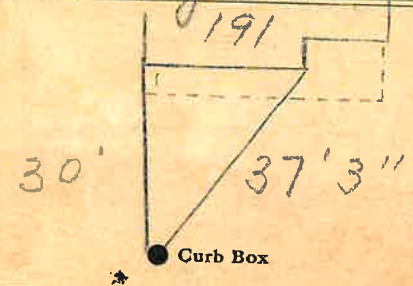

10" Main Elev. of Main at tap 6'

Gate at ● 3/4" Copper 34' to MAIN ● Gate at

● Curb Box

TAX ID# 303.18-19-11