

St. Warren St. Pl. Ave. No. 234

Name of Owner

Abrahams

Labor and Mat'l. Report Oct. 30 1952

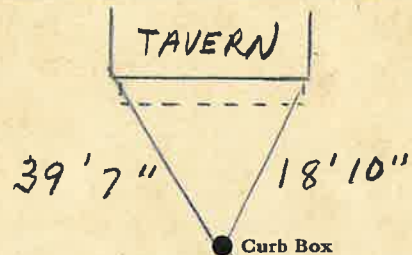

10" Main

Elev. of Main at tap 5'

Gate at ●

● Gate at

3/4" Copper

11' to MAIN

● Curb Box

TAX ID# 303.18-13-17

St. 236
-Pl. Warren
-Ave.-No.

Name of Owner

Michael Abraham
Commercial Auto Sales

Labor and Mat'l. Report May 20 1963

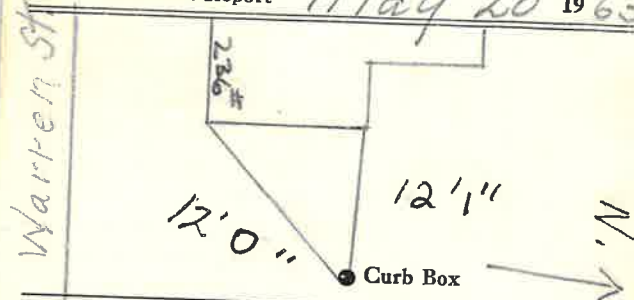

6 C.I. Geer St

Elev. of Main at tap 3 1/2'

Gate at ●

● Gate at

3/4" copper

28' to MAIN

● Curb Box

This Tap on
Geer St.

LABOR AND MATERIALS

| | | | | | |
|----|-------------------------|--------------------------|------------|----|--------|
| 1 | Copper Lead | Connection | 3/4" | \$ | 2.76 |
| 1 | Curb | Cock Valve | 3/4 in. | \$ | 3.49 |
| | | T. S. & V. | | | |
| 1 | Service box | Short 3 1/2 X 4 1/2 | | | |
| | Old returned | Long 4 1/2 X 5 1/2 | | | |
| | | Buff or Rdway | | \$ | 4.74 |
| 11 | Ft. | 3/4 in. Copper | Pipe at 35 | \$ | 3.85 |
| | | G. I. | | | |
| | | C. I. | | | |
| 1 | Nipples | 3/4 in. at | | \$ | 1.3 |
| 1 | Bushings | close 3/4" to 3/4 in. at | | \$ | 5.0 |
| | Red'g | | | | |
| | Inc'g | Coupl'gs to in. at | | \$ | |
| | Union | in. at | | \$ | |
| | Meter | in. at | | \$ | |
| | Lead Joints | at | | \$ | |
| | Compound Joints | at | | \$ | |
| 5 | Hrs. Water Maint. Man-1 | at 1.34 | | \$ | 6.70 |
| 14 | Hrs. Water Maint. Man-2 | at 1.24 | | \$ | 17.36 |
| | Hrs. Labor | at | | \$ | 6 |
| 34 | Hrs. Labor | at 1.13 | | \$ | 38.42 |
| 5 | Hrs. Compressor | at 1.50 | | \$ | 7.50 |
| | Compensation Ins. | at \$ 1.06 per C | | \$ | 2.32 |
| | Trucking | | | \$ | 1.00 |
| | Pay't Patch | | | \$ | 17.08 |
| | Tap by Gifford | | | \$ | |
| | 10-30-52 | | | \$ | |
| | O'head | | | \$ | |
| | | | | \$ | 106.85 |

LABOR AND MATERIALS

| | | | | | |
|----|-------------------------|---------------------|-----------------|----|--|
| 1 | Copper Lead | Connection | 3/4" | \$ | |
| 1 | Curb | Cock Valve | 3/4 in. or 1.50 | \$ | |
| | | T. S. & V. | | | |
| 1 | Service box | Short 3 1/2 x 4 1/2 | | | |
| | Old returned | Long 4 1/2 x 5 1/2 | | | |
| | | Buff or Rdway | | \$ | |
| 28 | Ft. | 3/4 in. Copper | Pipe at | \$ | |
| | | G. I. | | | |
| | | C. I. | | | |
| | Nipples | in. at | | \$ | |
| | Bushings | to in. at | | \$ | |
| | Red'g | | | | |
| | Inc'g | Coupl'gs to in. at | | \$ | |
| | Union | in. at | | \$ | |
| | Meter | in. at | | \$ | |
| | Lead Joints | at | | \$ | |
| | Compound Joints | at | | \$ | |
| | Maintenance Foreman | | | \$ | |
| | Hrs. Water Maint. Man-1 | at | | \$ | |
| | Hrs. Water Maint. Man-2 | at | | \$ | |
| | Hrs. Garage Foreman | at | | \$ | |
| | Hrs. Labor | at | | \$ | |
| | Hrs. Compressor | at | | \$ | |
| | Compensation Ins. | at \$ per C | | \$ | |
| | Trucking | | | \$ | |
| | Pay't Patch | | | \$ | |
| | Tap by Gifford | | | \$ | |
| | 7-10-52 | | | \$ | |
| | 5-20-63 | | | \$ | |
| | O'head | | | \$ | |
| | | | | \$ | |