

### Labor and Materials

Copper } Connection	\$
Lead } Connection	\$
Curb } Cock	in. \$
Valve	
T. S. & V. }	
Service Box } Short 3/4x4 1/2	\$
Old returned } Long 4 1/2x5 1/2	
Buff. or Rdway }	
224 Ft. 6" in. } Copper	Pipe at .77 \$172.45
Galv. Iron	
Cast Iron	
Nipples	in. at. \$
Bushings	to in. at. \$
Red'g } Couplings	to in. at. \$
Inc'g }	
Union	in. at. \$
Meter	in. at. \$
Lbs. Br. Stone	at. \$
Lbs. Sand	at. \$
Bags Cement	'at. \$
Paving Brick } Mack	} at. \$
Red	
Asphalt	
1 Lead Joints	at. 6" \$ 1.32
13 Leadite Joints	at. \$ 5.46
17 Hrs. Foreman	at. \$ 10.63
23 Hrs. Tapper	at. \$ 11.50
19 1/2 Hrs. Common Labor	at. \$ 77.80
Hrs. Mason	at. \$
Hrs. Mason's Helper	at. \$
Hrs. Compressor	at. \$
Compensation Ins.	\$ 2.66
Trucking	\$ 5.10
Builders' Use of Water	\$
Total \$ 286.85	

\$ 1.28 + \$ 10.00

Labor and Material Report Sept 7 1929

Extension Water at main

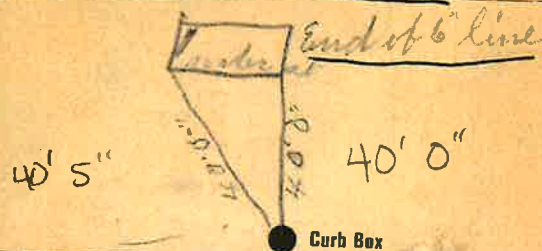

6" Main Water St. Eley of Main at tap 4 ft

Gate at ●

● Gate at

● Curb Box

14 8' length pipe water at  
1- lead joint  
13 leadite "  
gate