

LABOR AND MATERIALS

1	Copper Lead	{ Connection $\frac{3}{4}$	\$ 2.29
1	Curb	{ Cock Valve T.S. & V. } $\frac{3}{4}$ in.	\$ 2.70
1	Service box Old returned	{ Short $3\frac{1}{2} \times 4\frac{1}{2}$ Long $4\frac{1}{2} \times 5\frac{1}{2}$ Buff or Rdway }	\$ 4.25
9	Ft. $\frac{3}{4}$ in.	{ Copper G. I. C. I. } Pipe at 35	\$ 3.15
	Nipples	in. at	\$
	Bushings	to in. at	\$
	Red'g Inc'g	{ Coupl'gs to in. at	\$
	Union	in. at	\$
	Meter	in. at	\$
	Lead Joints at		\$
	Compound Joints at		\$
	Hrs. Water Maint. Man-1	at	\$
10	Hrs. Water Maint. Man-2	at 1.02	\$ 7.14
	Hrs. Labor	at 91	\$ 9.10
	Hrs. Labor	at	\$
3	Hrs. Compressor at	1.20	\$ 3.60
	Compensation Ins. at \$	per C.	\$ 36
	Trucking		\$ 1.00
	Pav't Patch		\$ 14.18
	Top by Warrinski		\$
	O'head		\$
			\$ 47.77

57-1450

St. Pl. Ave. No. 22
24

Name of Owner Webster Ave
Island

Labor and Mat'l. Report June 2 1950

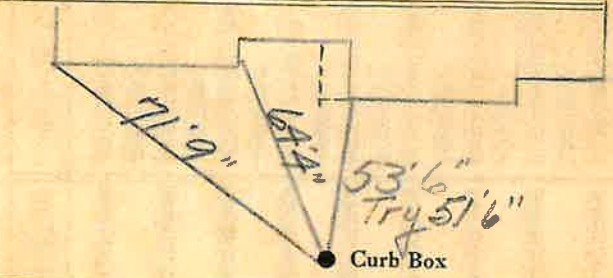

12 Main Elev. of Main at tap 7

Gate at ● ● Gate at

9' to main

● Curb Box

TAP ON WEBSTER AVE.

TAX ID# 302.11-3-30

LSM-SC 10-21-49