

LABOR AND MATERIALS

" No 1/4 Bend.

1	Copper	Connection	3/4	\$	
1	Lead	Cock	3/4 in.	\$	
1	Curb	Valve	3/4 in.	\$	
		T.S. & V.			
1	Service box	Short 3 1/2 x 4 1/2		\$	
	Old returned	Long 4 1/2 x 5 1/2			
		Buff or Rdway			
10	Ft.	Copper		\$	
	3/4 in.	G.I.			
	Adapter	G.I.			
1	Nipples	3/4 in. at (Male)		\$	
	Bushings	to in. at		\$	
1	Red'g	Coupl'gs.	1 to 3/4 Brass	\$	
	In'g				
	Union	in. at		\$	
	Meter	in. at		\$	
	Lead Joints at			\$	
	Compound Joints at			\$	
	Maintenance Foreman			\$	
	Hrs. Water Maint. Man-1 at			\$	
	Hrs. Water Maint. Man-2 at			\$	
	Hrs. Garage Foreman at			\$	
	Hrs. Labor at			\$	
	Hrs. Compressor at			\$	
	Compensation Ins. at \$	per C		\$	
	Trucking			\$	
	Pav't Patch			\$	
	Tap by Miller, Gifford & Co			\$	
	3-26-58			\$	
	O'head			\$	

Webster St. Ave. No. 26

Name of Owner Chase.

Labor and Mat'l. Report Mar. 26 1958

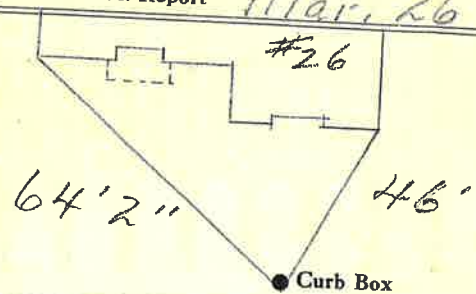

12" Main Elev. of Main at tap 4'

Gate at • Gate at •

10' to MAIN

• Curb Box

Tap on side of main.
10/22 - not on map