

LABOR AND MATERIALS

1 Copper Connection <sup>3/4"</sup> \$

1 Curb { Cock Valve } <sup>3/4"</sup> in. \$

1 Service Box { Short 3 1/2 x 4 1/2 } \$

Old returned { Long 4 1/2 x 5 1/2 } \$

35 Ft. <sup>3/4"</sup> in. { Copper } Pipe at \$

~~Galv. Iron~~

~~Cast Iron~~

Nipples in. at \$

Bushings to in. at \$

Red'g } Couplings to in. at \$

Inc'g }

Union in. at \$

Meter in. at \$

Lead Joints at \$

Leadite Joints at \$

Hrs. Foreman at \$

Hrs. Chauffeur at \$

Hrs. Tapper at \$

Hrs. Labor at \$

Hrs. Labor at \$

Hrs. Compressor at \$

Compensation Ins. \$

Trucking \$

Builders Use of Water \$

\$

\$

\$

\$

\$

\$

\$

St. Webster

Pl. 35

Ave. No. 35

Name of Owner Dugan Curb & Foundry

TAX ID # 302.11-6-8

Labor and Mat'l. Report 7-21-39 1939

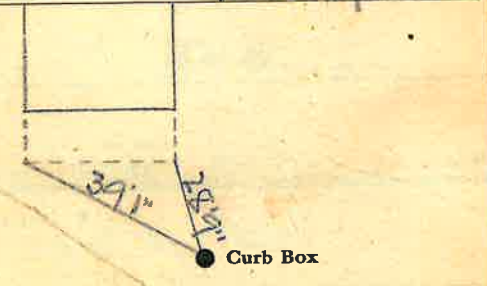

12" Main Elev. of Main at tap 3 1/2

Gate at ● Gate at ●

35' to MAIN

● Curb Box

Mrs. Mary Hogan