

### LABOR AND MATERIALS

Copper	}	Connection			\$
Lead					
Curb	}	Cock Valve	in.		\$
		T. S. & V.			
Service Box					
Old returned	}	Short 3 1/2 x 4 1/2			\$
		Long 4 1/2 x 5 1/2			
		Buff. or Rdway			
Ft.	}	Copper	Pipe at		\$
		Galv Iron			
		Cast Iron			
in.					
Nipples		in.	at		\$
Bushings		to	in.	at	\$
Red'g	}	Couplings	to	in.	at
Inc'g					
Union		in.	at		\$
Meter		in.	at		\$
Lead Joints			at		\$
Leadite Joints			at		\$
Hrs. Foreman			at		\$
Hrs. Chauffeur			at		\$
Hrs. Tapper			at		\$
Hrs. Labor			at		\$
Hrs. Labor			at		\$
Hrs. Compressor			at		\$
Compensation Ins.					\$
Trucking					\$
Builders Use of Water					\$
					\$
					\$
					\$
					\$
					\$

St  
Pt.

Webster

Ave. No. 18

Name of Owner

TAX ID# 302.11-3-26

Labor and Mat'l. Report

7-19-39

19

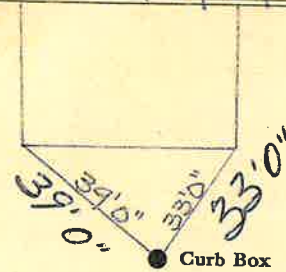

Main

Elev. of  
Main at tap

Gate at

Gate at

● Curb Box

H.C. Stafford