

LABOR AND MATERIALS

1	Copper	Connection	3/4"	\$	2.76
1	Lead	Cock	3/4 in.	\$	3.49
1	Curb	Valve	3/4 in.	\$	3.49
		T. S. & V.			
1	Service box	Short 3/2 X 4/2		\$	4.74
	Old returned	Long 4/2 X 5/2		\$	
		Buff or Rdway		\$	
34	Ft.	Copper	3/4 in.	Pipe at	38 \$12.92
		G.I.			
		C.I.			
	Nipples	in. at		\$	
	Bushings	to in. at		\$	
	Red'g			\$	
	Inc'g	Coupl'gs to in. at		\$	
	Union	in. at		\$	
	Meter	in. at		\$	
	Lead Joints	at		\$	
	Compound Joints	at		\$	
	Hrs. Water Maint. Man-1	at		\$	
9	Hrs. Water Maint. Man-2	at	1.24	\$	9.92
16	Hrs. Labor	at	1.13	\$	18.08
	Hrs. Labor	at		\$	
	Hrs. Compressor	at		\$	
	Compensation Ins.	at \$ 4.406 per C		\$	1.23
	Trucking			\$	1.50
	Pav't Patch			\$	16.20
	Tap by G. S. GORD	8-28-53		\$	
				\$	
				\$	
	O'head			\$	

\$70.34

54.14

533
Western Ave. South
Cortine
Pl. Ave. No. 21

Name of Owner
Lebowitz

Labor and Mat'l. Report Aug. 28 1953

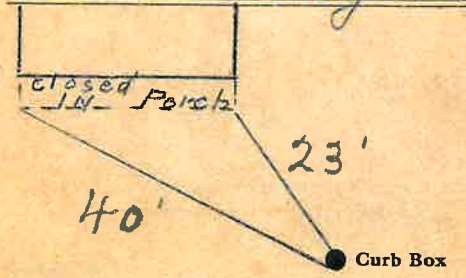

12" Main Elev. of Main at tap 5'

Gate at ● Gate at ●
34' to main

● Curb Box

TAX ID # 309.7-10-35