

LABOR AND MATERIALS

1	Copper Lead	Connection	3/4"	\$	2.41
1	Curb	Cock Valve T.S. & V.	3/4 in.	\$	3.41
Some	Service box	Short 3 1/2 x 4 1/2		\$	
Old returned		Long 4 1/2 x 5 1/2		\$	
		Buff or Rdway		\$	
12	Ft.	Copper G.I. G.I.	3/4 in. Pipe at 40	\$	4.80
	Nipples	in. at		\$	
	Bushings	to in. at		\$	
	Red'g Inc'g	Coupl'gs to in. at		\$	
	Union	in. at		\$	
	Meter	in. at		\$	
	Lead Joints	at		\$	
	Compound Joints	at		\$	
	Maintenance Foreman			\$	
	Hrs. Water Maint. Man-1	at		\$	
11	Hrs. Water Maint. Man-2	at 1.24		\$	13.64
2	Hrs. Garage Foreman	at 1.59		\$	3.18
11	Hrs. Labor	at 1.13		\$	12.43
	Hrs. Compressor at			\$	
	Compensation Ins. at \$	3.861 per C.		\$	1.13
	Trucking			\$	1.50
	Pay't Patch			\$	11.20
	Tap made May 21-54			\$	
	By G. J. Forde & Mad. Kipph			\$	
	O'head			\$	
				\$	53.70

42.50

27-54

William
 St. Pt. Ave. No. 18
 Name of Owner
 Alton Keene

Labor and Mat'l. Report May 21 1954

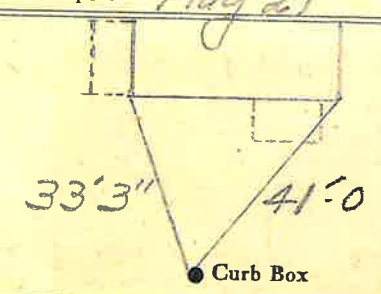

4' Main Elev. of Main at tap 5 1/2'
 Gate at • Gate at
 12' to main
 • Curb Box

TAX ID# 302.16-15-35