

LABOR AND MATERIALS

1 Copper } Connection 3/4" \$  
  Lead }  
1 Curb } Cock } 3/4 in. Or seal. \$  
          } Valve }  
          } T.S. & V. }  
1 Service box { Short 3 1/2 x 4 1/2 }  
  Old returned { Long 4 1/2 x 5 1/2 } \$  
                  { Buff or Rdway }  
11 Ft. 3/4 in. { Copper } Pipe at \$  
                  { G.I. }  
                  { G.I. }  
Nipples in. at \$  
Bushings to in. at \$  
Red'g }  
Inc'g } Coupl'gs to in. at \$  
Union in. at \$  
Meter in. at \$  
Lead Joints at \$  
Compound Joints at \$  
Maintenance Foreman \$  
Hrs. Water Maint. Man-1 at \$  
Hrs. Water Maint. Man-2 at \$  
Hrs. Garage Foreman at \$  
Hrs. Labor at \$  
Hrs. Compressor at \$  
Compensation Ins. at \$ per C \$  
Trucking \$  
Pav't Patch \$  
Tap by Seymour & Co. \$  
                  8-26-71 \$  
O'head \$  
\$

St. William  
Pl. Ave. No. 20

Name of Owner Emanuel Pissare.

Labor and Mat'l. Report Aug. 26 19 71

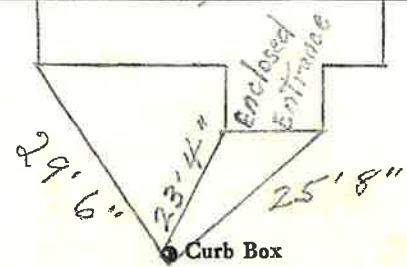

4" Main Elev. of Main at tap

Gate at • Gate at •  
11' to main

• Curb Box

TAX ID # 302.16-15-36