

20

LABOR AND MATERIALS

1	Copper Lead	Connection	3/4"	\$
1	Curb	Cock Valve F. S. & V.	3/4" Oriseal	\$
1	Service Box	Short 3 1/2 x 4 1/2		\$
	Old returned	Long 4 1/2 x 5 1/2		\$
12	Ft. 3/4 in.	Buff. or Rdway		\$
		Copper		\$
		Galv Iron		\$
		Cast Iron		\$
	Nipples	in. at		\$
	Bushings	to in. at		\$
	Red'g Inc'g	Couplings to in. at		\$
	Union	in. at		\$
	Meter	in. at		\$
	Lead Joints	at		\$
	Leadite Joints	at		\$
	Hrs. Foreman	at		\$
	Hrs. Chauffeur	at		\$
	Hrs. Tapper	at		\$
	Hrs. Labor	at		\$
	Hrs. Labor	at		\$
	Hrs. Compressor	at		\$
	Compensation Ins.			\$
	Trucking			\$
	Builders Use of Water			\$
	Tap by Gifford & Co.			\$
	8-4-64.			\$
				\$
				\$

St.

Pl.

Ave. No. 20

Wilmot

Name of Owner

Francis Buckley

Labor and Mat'l. Report

Aug. 4

1964

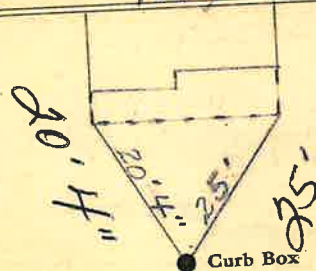

6" Main

Elev. of Main at tap 5'

Gate at ●

● Gate at

12' to MAIN

● Curb Box

TAX ID# 309.7-9-20