

Labor and Materials

Copper } Connection.....	3	\$ 1.48
Lead } .....		
Curb { Cock Valve } .....	3	\$ 1.79
Service Box { Short 3 1/2 x 4 1/2 } .....		\$ 1.30
Old returned { Long 4 1/2 x 5 1/2 } .....		
18 Ft. .... in. { Copper } Pipe at .....	3	\$ 3.24
Nipples .....		
Bushings .....		
Red'g } Couplings..... to .....		
Inc'g } .....		
Union..... in. at .....		
Meter..... in. at .....		
Lbs. Br. Stone at .....		
Lbs. Sand at .....		
Bags Cement at .....		
Paving Brick { Mack Red Asphalt } at .....		
Lead Joints at .....		
Leadite Joints at .....		
4 Hrs. Foreman at .....		\$ 2.50
8 Hrs. Common Labor at .....		\$ 3.60
Hrs. Common Labor at .....		
Hrs. Mason at .....		
Hrs. Masons Helper at .....		
Hrs. Compressor at .....		
Compensation Ins .....		\$ 1.19
Trucking .....		\$ 1.00
Builders Use of Water Patch .....		\$ 5.00
Total \$		20.10

5 32-137  
 Labor and Material Report Nov 15 1932

9 Wilmet ST

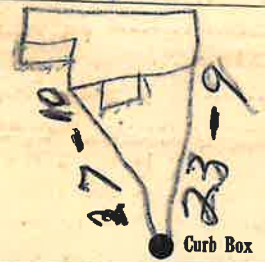

6 Main Elev. of Main at tap 4 1/2  
 Gate at • 18' to MAIN • Gate at

● Curb Box

old Tap shut off at Main  
 TAX ID# 309.7-8-6

PK [Signature]