

LABOR AND MATERIALS

1	Copper Lead	Connection	3/4"	\$	
1	Curb	Cock Valve T.S. & V.	3/4" in.	\$	
1	Service box	Short 3 1/2 x 4 1/2 Long 4 1/2 x 5 1/2 Buff or Rdway		\$	
	Old returned				
2.5	Ft	Copper G.I. C.I.	3/4" in.	Pipe at	\$
	Nipples		in. at	\$	
	Bushings		to in. at	\$	
	Red'g Inc'g	Coupl'gs	to in. at	\$	
	Union		in. at	\$	
	Meter		in. at	\$	
	Lead Joints		at	\$	
	Compound Joints		at	\$	
	Maintenance Foreman			\$	
	Hrs. Water Maint. Man	1 at		\$	
	Hrs. Water Maint. Man	2 at		\$	
	Hrs. Garage Foreman	at		\$	
	Hrs. Labor	at		\$	
	Hrs. Compressor	at		\$	
	Compensation Ins.	at \$	per C	\$	
	Trucking			\$	
	Pav't Patch			\$	
	Tap by Gifford & Co.			\$	
			6-24-63	\$	
	O'head			\$	

Lot-14

Windy Hill Rd. St. 14
Pt. 15
Ave. No. 15

Name of Owner J. Wheeler
TAX ID # 303.9-7-6

Labor and Mat'l. Report June 24 19 63

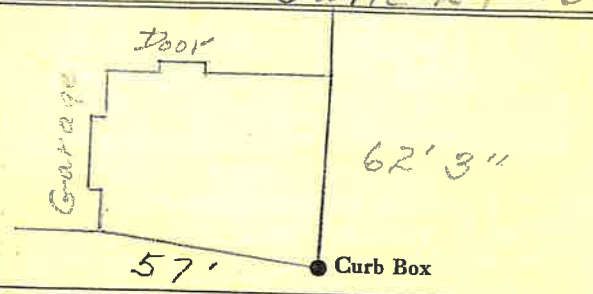

6" C.I. Main Elev. of Main at tap 5'

Gate at ● Gate at ●
25' to main
● Curb Box