

LABOR AND MATERIALS

1	Copper	} Connection		\$
	Lead			
1	Curb	} Cock Valve T.S. & V.	3/4 in.	\$
1	Service box	} Short 3 1/2 x 4 1/2 Long 4 1/2 x 5 1/2 Buff Rdway		\$
	Old returned			
13	Ft. 3/4 in.		} Copper C.I. C.I.	Pipe at
	Nipples	in. at		\$
	Bushings	to in. at		\$
	Red'g	} Coupl'gs	to in. at	\$
	Inc'g			
	Union	in. at		\$
	Meter	in. at		\$
	Lead Joints	at		\$
	Compound Joints	at		\$
	Maintenance Foreman			\$
	Hrs. Water Maint. Man-1	at		\$
	Hrs. Water Maint. Man-2	at		\$
	Hrs. Garage Foreman	at		\$
	Hrs. Labor	at		\$
	Hrs. Compressor	at		\$
	Compensation Ins. at \$	per C		\$
	Trucking			\$
	Pav't Patch			\$
	<i>Tap made by Beecher</i>			\$
	<i>July-29-1975</i>			\$
	O'head			\$

Windy Hill Rd. St Ave. No. 20

Name of Owner George Frey

Labor and Mat'l. Report July 29 1975

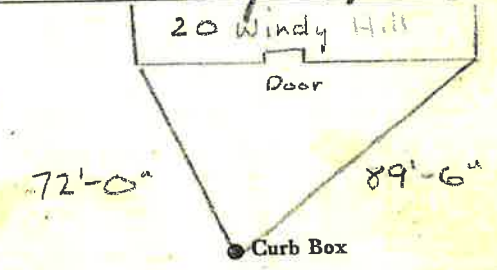

6" Main Elev. of Main at top 5 1/2'

Gate at • Gate at
13' to MAIN

• Curb Box
TAX ID# 303.9-7-9