

WINDY RIDGE

DR.
St.
Pt.
Ave. No. 2

4

Name of Owner

WHIPPLE, ROBERT

Labor and Mat'l. Report

19 98

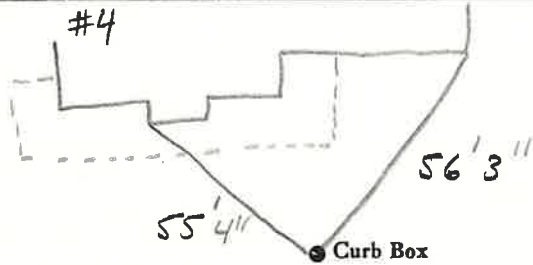

Main

Elev. of
Main at tap

Gate at •

• Gate at

• Curb Box

WINDY RIDGE

DR.
St.
Pt.
Ave. No. 4

4

Name of Owner

TAX ID # 303.9-8-2

Labor and Mat'l. Report

19 99

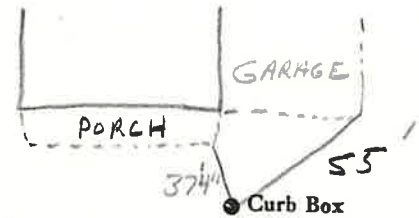

Main

Elev. of
Main at tap

Gate at •

• Gate at

• Curb Box

