

Labor and Materials

Copper } Connection	3	\$ 3.20
Lead } Connection	3	\$ 3.20
Curb } Cock	1	\$ 1.00
Valve		
T. S. & V. }	in. at	
Service Box } Short 3 1/2 x 4 1/2		
Old returned } Long 4 1/2 x 5 1/2		\$ 1.20
	Butt. or Railway	
2 Ft. } in. } Copper	3	\$ 2.64
Nipples	in. at	\$
Bushings	3/4 to 1 in. at	\$.08
Red'g } Couplings	to in. at	\$.15
Inc'g }		
Union	in. at	\$
Meter	in. at	\$
Lbs. Br. Stone	at	\$
Lbs. Sand	at	\$
Bags Cement	at	\$
Paving Brick } Mack		
Red		
Asphalt }	at	\$
Lead Joints	at	\$
Leadite Joints	at	\$
2 Hrs. Foreman	at 62.5	\$ 12.5
Hrs. Common Labor	at	\$
8 Hrs. Common Labor	at 40.1	\$ 32.1
Hrs. Mason	at	\$
Hrs. Mason's Helper	at	\$
Hrs. Compressor	at	\$
Compensation Ins.		\$ 13
Trucking		\$ 1.00
Builders' Use of Water		\$
Total		\$ 14.00

26-133

Labor and Material Report

19 26

13

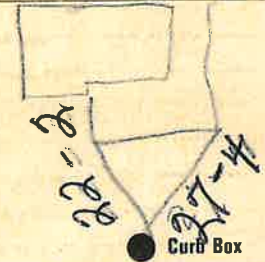

Main

Elev. of Main at tap 4 1/2

Gate at ●

Gate at ●

12' to MAIN

● Curb Box

TAX ID# 303.13-2-14