

LABOR AND MATERIALS

1	Copper Lead	Connection	3/4"	\$	3.08
1	Curb	Cock Valve T.S. & V.	3/4 in.	\$	3.89
1	Service box	Short 3 1/2 x 4 1/2		\$	4.32
	Old returned	Long 4 1/2 x 5 1/2		\$	
		Buff or Rdway		\$	
30	Ft. 3/4 in.	Copper G.I. G.I.	Pipe at 45	\$	13.50
	Nipples	in. at		\$	
	Bushings	to in. at		\$	
	Red'g Inc'g	Coupl'gs to in. at		\$	
	Union	in. at		\$	
	Meter	in. at		\$	
	Lead Joints at			\$	
	Compound Joints at			\$	
	Maintenance Foreman			\$	
	Hrs. Water Maint. Man-1 at			\$	5.43
	Hrs. Water Maint. Man-2 at			\$	5
10	Hrs. Garage Foreman	at 2.033		\$	20.33
27	Hrs. Labor	at 1.30		\$	35.10
	Hrs. Compressor at			\$	
	Compensation Ins. at \$5.686 per C			\$	3.15
	Trucking			\$	1.50
	Pay't Patch			\$	7.20
	Tap by Lareau & Co.			\$	
	7-10-56			\$	
	O'head			\$	
				\$	92.07

St. Wing  
 Pl. Ave. No. 2  
 Name of Owner

Curtis

Labor and Mat'l. Report July 10 1956

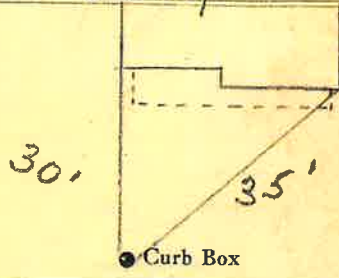

4" Main Elev. of Main at tap 4'

Gate at • Gate at

30' to main

• Curb Box

TAX ID# 303.13-1-1