

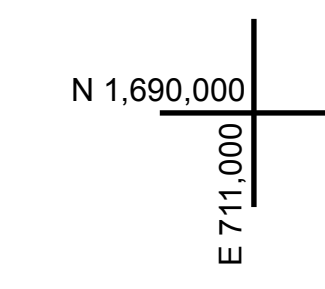

50	51	52	53	54	55
56	57	58	59	60	61
62	63	64	65	66	67

20	21	22	23	24	25
26	27	28	29	30	31
32	33	34	35	36	37
38	39	40	41	42	43

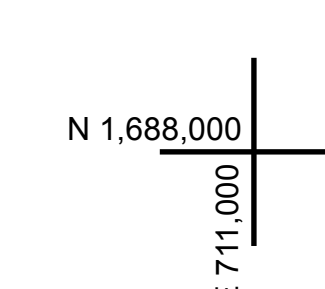

N 1,688,000
E 708,000



 PREPARED BY:
WARREN COUNTY REAL PROPERTY SERVICES
 LAKE GEORGE, NEW YORK

REVISION TABLE			
DATE	MADE BY	CHANGES OR ADDITIONS	

SPECIAL DISTRICTS	

PROPERTY LINE	
ORIGINAL LOT LINE	---
RAILROAD	—+—+—+—
STREAM OR DITCH	~~~~~
ROAD OR RAILWAY ENDY	---
COUNTY LINE	---

TOWN LINE	
VILLAGE LINE	---
BLOCK LIMIT	---
GREAT LOT LINE	---
SCHOOL DISTRICT LINE	---

LEGEND	
FIRE DISTRICT LINE	---
DENOTES COMMON OWNER	---
TAX MAP BLOCK NUMBER	7
TAX MAP PARCEL NUMBER	76.00-1-11
FILED PLAN LOT NUMBER	(14)

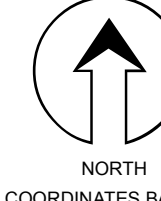
 NORTH
 COORDINATES BASED ON
 NEW YORK STATE PLANE COORDINATE SYSTEM
 (EASTERN ZONE NAD 83)

225.16	226.13
225.20	226.17
238.08	239.00

SHEET INDEX

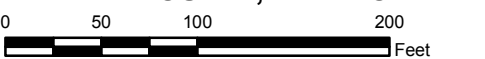
TAX MAP
TOWN OF LAKE GEORGE
 WARREN COUNTY, NEW YORK

 1 inch = 100 feet
 DATE PRINTED: Apr 11, 2011

226.17

THIS DOCUMENT PREPARED FOR TAX PURPOSES ONLY