



PREPARED BY:
WARREN COUNTY REAL PROPERTY SERVICES
 LAKE GEORGE, NEW YORK

REVISION TABLE		
DATE	MADE BY	CHANGES OR ADDITIONS
12/17/2010	P. DIXON	PANEL 308.13-1-4.11 SPLIT ORLE PARK SUBDIVISION NOW 308.13-1-4.11 PARCEL 308.09-1-13 CREATED.
4/22/2010	P. DIXON	307.00-1-31.1 REBROU INTO 308.09-1-7 (BY OWNER REQUEST DATED 3/15/10) AND DELETED FROM TAX MAP.
1/14/2010	N. DIXON	308.09-1-8 REBROU INTO 308.09-1-8. BY OWNER REQUEST DATED 1/11/10 AND DELETED FROM TAX MAP.

SPECIAL DISTRICTS	
PROPERTY LINE	—
ORIGINAL LOT LINE	- - - - -
RAILROAD	—+—+—+—
STREAM OR DITCH	~~~~~
ROAD OR RAILWAY BNDY	—+—+—+—
COUNTY LINE	—+—+—+—

LEGEND	
TOWN LINE	—+—+—+—
VILLAGE LINE	—+—+—+—
BLOCK LIMIT	—+—+—+—
GREAT LOT LINE	—+—+—+—
SCHOOL DISTRICT LINE	—+—+—+—
FIRE DISTRICT LINE	—+—+—+—
DENOTES COMMON OWNER	—+—+—+—
TAX MAP BLOCK NUMBER	7
TAX MAP PARCEL NUMBER	76.00-1-11
FILED PLAN LOT NUMBER	(14)

GREAT LOT NUMBER	76 (C)
CALCULATED ACREAGE	178 A
DEED ACREAGE	228 (B)
SCALED DIMENSION	173.2
DEED DIMENSION	173.2

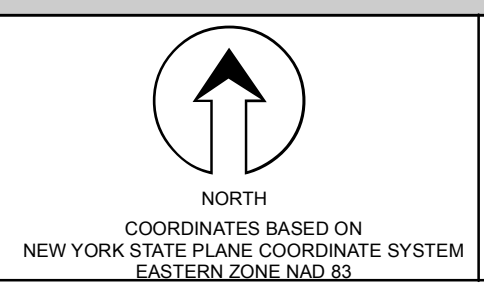

SHEET INDEX		
307.00	308.00	309.00
307.00	308.10	308.10
307.00	308.10	308.14

TAX MAP
TOWN OF QUEENSBURY
 WARREN COUNTY, NEW YORK
 SCALE: 1 inch = 100 feet
 DATE PRINTED: Apr 11, 2011

308.09

THIS DOCUMENT PREPARED FOR TAX PURPOSES ONLY