

N 1,732,000
E 660,000

N 1,732,000
E 666,000

E 660,000
N 1,728,000

N 1,728,000
E 666,000



PREPARED BY:
WARREN COUNTY REAL PROPERTY SERVICES
LAKE GEORGE, NEW YORK

REVISION TABLE			
DATE	MADE BY	CHANGES OR ADDITIONS	

SPECIAL DISTRICTS	

PROPERTY LINE		TOWN LINE		FIRE DISTRICT LINE	
ORIGINAL LOT LINE	---	VILLAGE LINE	---	DENOTES COMMON OWNER	---
RAILROAD	---	BLOCK LIMIT	---	TAX MAP BLOCK NUMBER	7
STREAM OR DITCH	---	GREAT LOT LINE	---	TAX MAP PARCEL NUMBER	76.00-1-11
ROAD OR RAILWAY BNDY	---	SCHOOL DISTRICT LINE	---	FILED PLAN LOT NUMBER	(14)
COUNTY LINE	---				

LEGEND	
GREAT LOT NUMBER	76
CALCULATED ACREAGE	76 (C)
DEED ACREAGE	176 A
SCALED DIMENSION	226 (B)
DEED DIMENSION	173.2

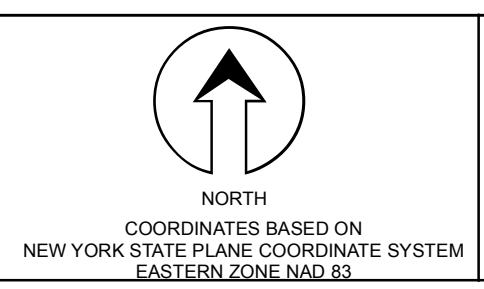

SHEET INDEX		
146.00	147.00	147.01

TAX MAP
TOWN OF THURMAN
WARREN COUNTY, NEW YORK

152.03
SCALE: 1 inch = 200 feet
DATE PRINTED: Apr 11, 2011

THIS DOCUMENT PREPARED FOR TAX PURPOSES ONLY